

## NJ322-E-XL-M1 FAG

SKU: FAGNJ322-E-M1

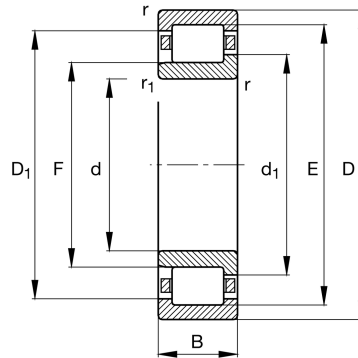

### Extra afbeelding



### Specificaties

<b>designation</b>	NJ322-E-XL-M1
<b>Boring diameter (mm)</b>	110
<b>Buitendiameter (mm)</b>	240
<b>Breedte (mm)</b>	50
<b>Eenheden</b>	pc
<b>Gewicht (kg)</b>	11.64
<b>Omschrijving (EN)</b>	Cylindrical roller bearing NJ..-E-XL-M1, with cage, single row, semi-locating bearing, 2 ribs on outer ring, 1 rib on inner ring, type NJ
<b>EAN-code</b>	4012801385442
<b>Merk</b>	FAG
<b>Boring diameter (mm)</b>	110
<b>Buitendiameter (mm)</b>	240
<b>Breedte (mm)</b>	50
<b>Gewicht (kg)</b>	11.64

## Beschrijving

NJ322-E-XL-M1 FAG Fixed outer ring - Inner ring slides one way (NJ, NH, NJG, LLRJA, MMRJA)

## Product URL

<https://aandrijftechniek.nl/product/nj322-e-xl-m1-fag/>