

## NJ222-E-XL-M1 FAG

SKU: FAGNJ222-E-M1

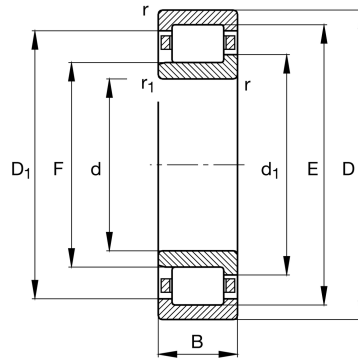

### Specificaties

|                             |   |
|-----------------------------|---|
| <b>designation</b>          | NJ222-E-XL-M1   |
| <b>Boring diameter (mm)</b> | 110   |
| <b>Buitendiameter (mm)</b>  | 200   |
| <b>Breedte (mm)</b>         | 38  |
| <b>Eenheden</b>             | pc  |
| <b>Gewicht (kg)</b>         | 5.5   |
| <b>Omschrijving (EN)</b>    | Cylindrical roller bearing NJ..-E-XL-M1, with cage, single row, semi-locating bearing, 2 ribs on outer ring, 1 rib on inner ring, type NJ |
| <b>EAN-code</b>             | 4012801380645   |
| <b>Merk</b>                 | FAG   |
| <b>Boring diameter (mm)</b> | 110   |
| <b>Buitendiameter (mm)</b>  | 200   |
| <b>Breedte (mm)</b>         | 38  |
| <b>Gewicht (kg)</b>         | 5.5   |

### Beschrijving

NJ222-E-XL-M1 FAG Fixed outer ring - Inner ring slides one way (NJ, NH, NJG, LLRJA, MMRJA)

## **Product URL**

<https://aandrijftechniek.nl/product/nj222-e-xl-m1-fag/>