

20B213 Neutral

SKU: 200KWD2012Z13

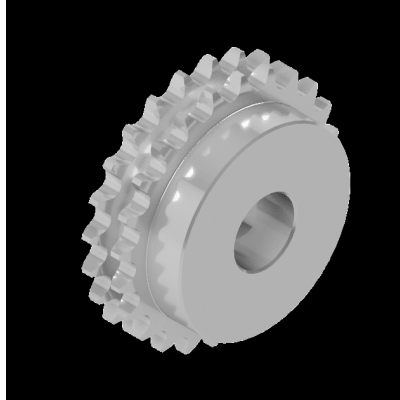

Specificaties

| | |
|-------------------------------|--------|
| Kettingsontwerp | Duplex |
| Oppervlaktebehandeling | No |
| Materiaal | C45 |
| Spoed (inch) | 1"1/4 |
| Spoed (mm) | 31.75 |
| ISO-standaardmaat | 20B |
| designation | 20B213 |
| Boring diameter (mm) | |
| Eenheden | pc |
| numberOfTeethZ | 13 |
| toothWidthMM | 54.6 |
| pilotBoreDiameterMM | 25 |
| pitchCircleDiameterMM | 132.65 |
| tipCircleDiameterMM | 147.5 |
| Geharde tanden | Nee |
| Gewicht (kg) | 5.7 |
| weldedHub | Nee |
| taperBushSize | |
| hubDiamDnMM | 100 |
| lengthInclHubLnMM | 80 |

| | |
|--|-----------|
| toothWidthb1MM | 18.2 |
| SprocketType | Standard |
| BEAArticleNumber | 102400013 |
| ISOstandardSize2 | ISO 606 |
| brandType(extraAttributeForNeutralIdentifier) | Extended |
| Merk | Neutral |
| Materiaal | C45 |
| Spoed (inch) | 1"1/4 |
| Spoed (mm) | 31.75 |
| Boring diameter (mm) | |
| Geharde tanden | Nee |
| Gewicht (kg) | 5.7 |

Beschrijving

20B Duplex Z 13, Standard Neutral Sprockets

Product URL

<https://aandrijftechniek.nl/product/20b213-neutral/>