

16B217 Neutral

SKU: 200KHD1611Z17

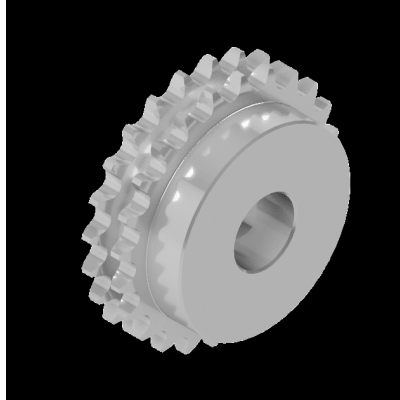

Specificaties

Kettingsontwerp	Duplex
Oppervlaktebehandeling	No
Materiaal	C45
Spoed (inch)	1"
Spoed (mm)	25.4
ISO-standaardmaat	ISO 606
designation	16B217
Boring diameter (mm)	
Eenheden	pc
numberOfTeethZ	17
toothWidthMM	47.7
pilotBoreDiameterMM	20
pitchCircleDiameterMM	138.22
tipCircleDiameterMM	149.8
Geharde tanden	Ja
Gewicht (kg)	5.98
weldedHub	Nee
taperBushSize	
hubDiamDnMM	112
lengthInclHubLnMM	70

toothWidthb1MM	15.8
SprocketType	Standard Induction hardened teeth
BEAArticleNumber	192380017
ISOstandardSize2	16B
brandType(extraAttributeForNeutralIdentifier)	Extended
Merk	Neutral
Materiaal	C45
Spoed (inch)	1"
Spoed (mm)	25.4
Boring diameter (mm)	
Geharde tanden	Ja
Gewicht (kg)	5.98

Beschrijving

ISO 606 Duplex Z 17, Standard Induction hardened teeth Neutral Sprockets

Product URL

<https://aandrijftechniek.nl/product/16b217-neutral-2/>