

10B223 Neutral

SKU: 200KHD106Z23

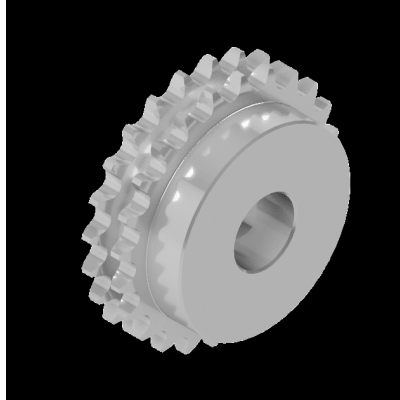

Specificaties

Kettingsontwerp	Duplex
Oppervlaktebehandeling	No
Materiaal	C45
Spoed (inch)	5/8"
Spoed (mm)	15.875
ISO-standaardmaat	ISO 606
designation	10B223
Boring diameter (mm)	
Eenheden	pc
numberOfTeethZ	23
toothWidthMM	25.5
pilotBoreDiameterMM	16
pitchCircleDiameterMM	116.58
tipCircleDiameterMM	123.5
Geharde tanden	Ja
Gewicht (kg)	2.82
weldedHub	Nee
taperBushSize	
hubDiamDnMM	95
lengthInclHubLnMM	45

toothWidthb1MM	9
SprocketType	Standard Induction hardened teeth
BEAArticleNumber	192350023
ISOstandardSize2	10B
brandType(extraAttributeForNeutralIdentifier)	Extended
Merk	Neutral
Materiaal	C45
Spoed (inch)	5/8"
Spoed (mm)	15.875
Boring diameter (mm)	
Geharde tanden	Ja
Gewicht (kg)	2.82

Beschrijving

ISO 606 Duplex Z 23, Standard Induction hardened teeth Neutral Sprockets

Product URL

<https://aandrijftechniek.nl/product/10b223-neutral-2/>